



SutureSeal™

Seal. Protect. Heal.

For additional information
please visit sutureseal.com
Scan for instructional video



SutureSeal Wound Sealant

1 application lasts up to 14 days

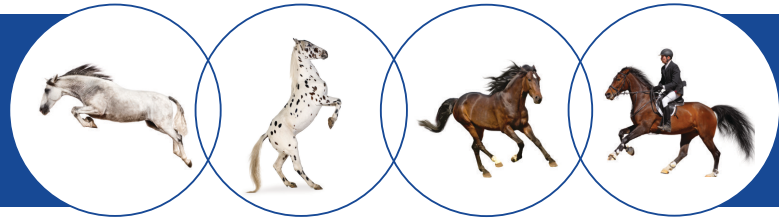

PREPARE

1. Open the foil pouch and remove the two syringes & application brush.
2. Remove the brush from the holder.
3. Remove the caps from both syringes & connect the two syringes with a clockwise twist.

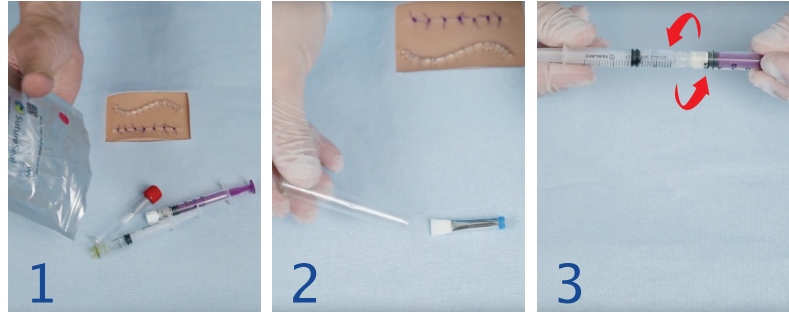

MIX

4. Mix the contents of the two syringes by vigorously pushing the plungers back & forth for approximately 30 strokes or 15–20 seconds, SutureSeal should be mixed to a milky white color.
5. When mixed, push all the liquid into the male syringe, disconnect the two syringes & attach application brush.

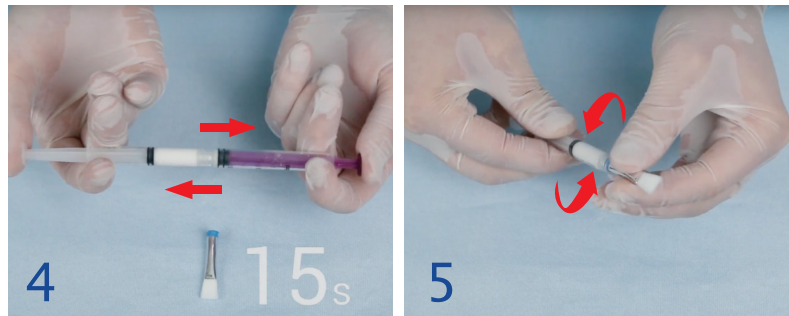

APPLY

6. Apply SutureSeal immediately to the suture or wound area.
7. Brush on evenly and completely cover the sutures & wound area.

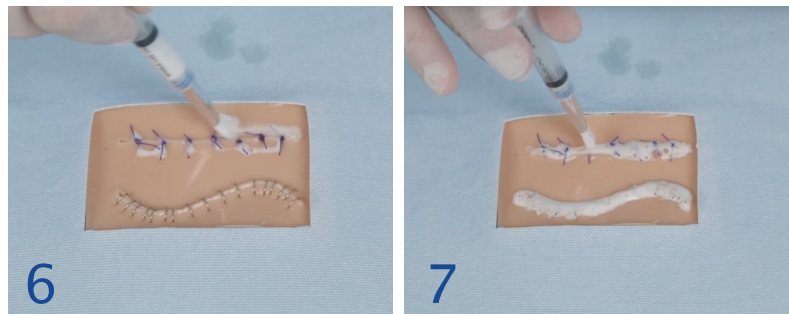

RESULTS

- SutureSeal gels into a clear, flexible sealant in approximately 80 to 120 seconds after mixing.
- SutureSeal will cover up to 15² cm.

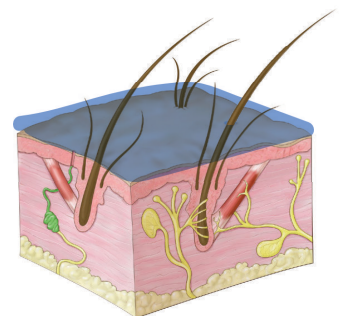
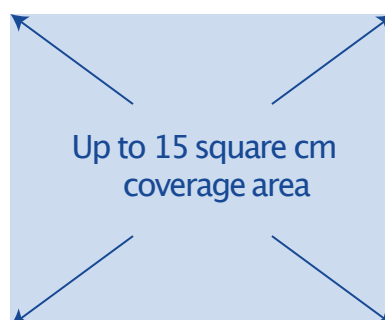

Mixing / Setup Guide